

FilterQuick Software Update Instructions

For updating fryers with software versions 0524 and before with Serial Numbers THAT BEGIN WITH DATE CODES PRIOR TO 1601

*******Prior to installing any software it is CRITICAL that ALL the settings from EACH controller be recorded on the following pages, as the following steps WILL OVERWRITE important fryer settings. Failure to capture and restore proper configurations may result in fryer malfunction.*******

To update the software follow the attached instructions. If you have any problems or questions call Frymaster at 1-800-551-8633.

* Press the FILTER button. Write down the setting in the right window (Filter Percent or Cooks Remaining) _____.

Check the setting of the hold mode on each controller by pressing and holding the ✓ button until **MAIN MENU** changing to **PRODUCT SETUP** is displayed. Press ► to scroll to **TECH MODE** and press the ✓ button. **ENTER CODE** is displayed. Press the ✓ button. Enter 3000. Press ► to scroll to **LANE COUNT**. Write down the setting _____. Press ► to scroll to **HOLD MODE**. Write down the setting _____. Press ► two (2) times to **EXIT**. Press the ✓ button. Press the exit scan button to exit to OFF. Repeat this step on each controller.

Follow these steps to record the following settings in the right display column of each controller:

Vat Set Up -- NOTE: Most of the system choices are only available on the far left controller.

****Starting with the LEFT CONTROLLER, with the controller displaying OFF, press ✓ until the controller scrolls Info Mode, changing to Main and then PRODUCT SETUP. Follow directions in action fields below.**

VAT SETUP

Left Display	VAT 1 Right Display	VAT 2 Right Display	VAT 3 Right Display	VAT 4 Right Display	VAT 5 Right Display	Action
OFF	OFF	OFF	OFF	OFF	OFF	See ** above.
PRODUCT SETUP	N/A	N/A	N/A	N/A	N/A	Press ► to scroll to Vat setup and press ✓.
VAT SETUP	ENTER CODE	ENTER CODE	ENTER CODE	ENTER CODE	ENTER CODE	Enter 1656.
SYSTEM		N/A	N/A	N/A	N/A	Press ✓.
LANGUAGE		N/A	N/A	N/A	N/A	Press ►.
2ND LANGUAGE		N/A	N/A	N/A	N/A	Press ►.
LOCALE		N/A	N/A	N/A	N/A	Press ►.



FilterQuick Software Update Instructions

For updating fryers with software versions 0524 and before with Serial Numbers THAT BEGIN WITH DATE CODES PRIOR TO 1601

Left Display	VAT 1 Right Display	VAT 2 Right Display	VAT 3 Right Display	VAT 4 Right Display	VAT 5 Right Display	Action
ENERGY		N/A	N/A	N/A	N/A	Press ►.
TYPE						Press ►.
SYSTEM VOLUME		N/A	N/A	N/A	N/A	Press ►.
TEMPR FORMAT		N/A	N/A	N/A	N/A	Press ►.
EXIT MELT TEMPR		N/A	N/A	N/A	N/A	Press ►.
COOL MODE TEMPR		N/A	N/A	N/A	N/A	Press ►.
COOL MODE DEFAULT		N/A	N/A	N/A	N/A	Press ►.
FRESH OIL		N/A	N/A	N/A	N/A	Press ►.
WASTE		N/A	N/A	N/A	N/A	Press ►.
RECOVERY ALARM		N/A	N/A	N/A	N/A	Press ►. Default is disabled.
BASKET LIFT						Press ►. Default is disabled.
HOLD TIME		N/A	N/A	N/A	N/A	Press ►.
EXIT	EXIT	EXIT	EXIT	EXIT	EXIT	Press ✓ button once to return the controller to OFF.

FILTER SETUP

Left Display	VAT 1 Right Display	VAT 2 Right Display	VAT 3 Right Display	VAT 4 Right Display	VAT 5 Right Display	Action
FILTER						
OFF	OFF	OFF	OFF	OFF	OFF	See ** on page 1.
PRODUCT SETUP	N/A	N/A	N/A	N/A	N/A	Press ► to scroll to Vat setup and press ✓.
VAT SETUP	ENTER CODE	ENTER CODE	ENTER CODE	ENTER CODE	ENTER CODE	Enter 1656.
SYSTEM						Press ► to scroll to FILTER.
FILTER						Press ✓.
COOKS TILL FILTER						Press ►.

FilterQuick Software Update Instructions

For updating fryers with software versions 0524 and before with Serial Numbers THAT BEGIN WITH DATE CODES PRIOR TO 1601

Left Display	VAT 1 Right Display	VAT 2 Right Display	VAT 3 Right Display	VAT 4 Right Display	VAT 5 Right Display	Action
FILTER LOCKOUT See NOTE ON PAGE 7.						Press ►.
EOD FILTER TIMER						Press ►.
EOD FILTER TIME						Press ►.
FLUSHING TIMER						Press ►.
CLEAN						Press ►.
CLEAN TIMER						Press ►.
POLISH LOCKOUT						Press ►.
1 POLISH TIMER						Press ►.
1 POLISH PROMPT TIME						Press ►.
1 POLISH DELAY TIMER						Press ►.
1 POLISH DURATION						Press ►.
ENABLE FILTERS PERCENT	*Captured at top of page 1.	N/A	N/A	N/A	N/A	Press ►.
1 POLISH START TEMPR						Press ►.
CLEAN AND FILTER TIMER						Press ►.
CLEAN AND FILTER PROMPT TIME						Press ►.
CLEAN AND FILTER DELAY TIMER						Press ►.

FilterQuick Software Update Instructions

For updating fryers with software versions 0524 and before with Serial Numbers THAT BEGIN WITH DATE CODES PRIOR TO 1601

Left Display	VAT 1 Right Display	VAT 2 Right Display	VAT 3 Right Display	VAT 4 Right Display	VAT 5 Right Display	Action
CLEAN AND FILTER START TEMPR						Press ►.
CHANGE FILTER PAPER INTERVAL H	25	N/A	N/A	N/A	N/A	Press ►. This is a new feature with version 0529. (This is the amount of time in hours after the filter paper has been changed before the next prompt will occur.) (The default is set to 25 hours.) If the value = 0, the CHANGE FILTER PAPER prompt is disabled.
OQS		N/A	N/A	N/A	N/A	Press ►.
CLEAN AND FILTER WITH OQS	CHOICE	N/A	N/A	N/A	N/A	Press ►. (Only displayed if OQS is Enabled) This is a new feature with version 0529. It must be set to a value other than NO to prompt for OQS during Clean and Filter. Set to CHOICE = Prompts for OQS during CLEAN AND FILTER. YES = Performs OQS during CLEAN AND FILTER without a prompt. NO= OQS is disabled during CLEAN AND FILTER.
OQS TYPE		N/A	N/A	N/A	N/A	Press ►. (Only displayed if OQS is Enabled)
DISPLAY TYPE		N/A	N/A	N/A	N/A	Press ►. (Only displayed if OQS is Enabled)
DISCARD NOW		N/A	N/A	N/A	N/A	Press ►. (Only displayed if OQS is Enabled)
DISCARD SOON		N/A	N/A	N/A	N/A	Press ►. (Only displayed if OQS is Enabled)
DISPOSE DELAY TIMER		N/A	N/A	N/A	N/A	Press ►. (Only displayed if OQS is Enabled)
EXIT	EXIT	EXIT	EXIT	EXIT	EXIT	Press the Exit/Scan button once to return the controller to OFF.

FilterQuick Software Update Instructions

For updating fryers with software versions 0524 and before with Serial Numbers THAT BEGIN WITH DATE CODES PRIOR TO 1601

Loading and Updating Software Procedures

Updating the software takes approximately 30 minutes. The software only needs to be loaded in **ONE** controller and it will update **all** the controllers and boards in the system. Typically this is done on the far left controller. To update the software, follow these steps carefully:

1. Switch all controllers to **OFF**. Press the temperature button to check current 3000/MIB/AIF/ATO and OQS (if applicable) software versions. Write down the current software versions to reference later.
2. Remove the bezel by removing the screws under the bottom of the bezel.
3. Remove the two screws holding the controller in place. Swing the controller down then remove the two screws on the left side cover plate of the controller board.
4. With the controller folded down, insert the SD card, with the contacts facing down and the notch on the bottom right (see Figure 1 and 2), into the slot on the left side of the controller.
5. Once inserted, **UPGRADE IN PROGRESS** appears on the left display and **WAIT** on the right.
6. The display then changes to **CC UPDATING** on the left and the percentage completed appears on the right. The display counts up to 100 on the right, changing to a flashing **BOOT. DO NOT REMOVE THE CARD UNTIL THE DISPLAY PROMPTS TO DO SO IN STEP 8.**
7. Then **UPGRADE IN PROGRESS** is displayed on the left display and **WAIT** on the right again followed by **IF_COOK HEX**, **IF_MIB HEX**, **IF_AIF HEX** ending with **IF_ATO HEX** or **IF_OQS HEX** displayed on the left and the percentage complete on the right.
8. The display then changes to **REMOVE SD CARD** on the left and **100** on the right.
9. Remove the SD card using the fingernail slot on the top of the SD card.
10. Once the SD card is removed the display changes to **CYCLE POWER**.
11. Cycle the control power using the hidden reset momentary rocker switch under the left control box in gas (see Figure 4) or behind the right control box over the JIB in electric (see Figure 5). **HOLD THE SWITCH FOR 15 SECONDS ENSURING THE MIB BOARD HAS POWERED FULLY DOWN. WAIT ANOTHER 20 SECONDS UNTIL THE MIB BOARD HAS FULLY RESET BEFORE CONTINUING.**
12. The left controller displays **OFF**. The remaining controllers display a flashing **BOOT** while the program is transferred.
13. When the update is complete the controller displays **OFF**. The MIB display will display **A** when the board is completely rebooted.
14. **With the controller displaying OFF, VERIFY software update by pressing the TEMP button to view updated 3000/MIB/AIF/ATO and OQS (if applicable) software versions on each controller. The software versions should read COOK 55.0529.05, MIB 35.0529.00, AIF 35.0529.00, ATO1 35.0529.00 and OQS 80.0110.00. IF ANY BOARDS DID NOT UPDATE, REPEAT THE PROCESS STARTING WITH STEP 4.**
15. Once the software has been updated and the versions are correct, replace the cover and screws covering the SD card slot and reinstall the screws attaching the controllers and bezel by reversing steps 2 through 3.



Figure 1



Figure 2

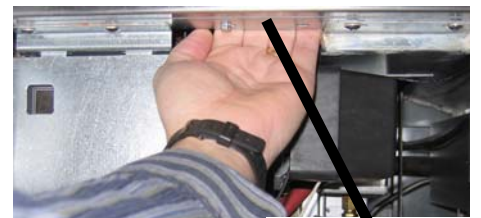

Figure 4



Figure 5

FilterQuick Software Update Instructions

For updating fryers with software versions 0524 and before with Serial Numbers THAT BEGIN WITH DATE CODES PRIOR TO 1601

Loading new software parameters

To load the new parameters of the software after the settings have been recorded follow the steps below and perform on each controller.

1. Start with the far LEFT controller. With the controller displaying OFF, press and hold the ✓ (check) key until the controller displays *INFO MODE* changing to *MAIN MENU* for three seconds changing to *PRODUCT SETUP*.
2. Press the ► (right) arrow key two times until *TECH MODE* is displayed. Press the ✓ (check) key.
3. Enter code 7628.
4. Follow the sequence below to configure the controller.

Left Display	Right Display	Action
LOCALE	NON-CE	Press ▼▲ to scroll to choice CE, CE Belgium or Non-CE and press ►. NOTE: CE should only be selected for countries in the European Common Union or those that follow the EU standards.
SYSTEM TYPE	FILTER QUICK	Press ►. ***NOTE: Do not change this setting.***
ENERGY TYPE	GAS	Press ▼▲ to choose Gas or Electric. Press ►.
FRESH OIL	JIB	Press ▼▲ to choose model and vat type. Press ►.
WASTE	SDU	Press ▼▲ to choose JIB or Bulk. Press ►.
RESET PRODUCTS	NO	Press ▼▲ to choose SDU, Bulk Press ►. With NO displayed press ►. NOTE: Change this with caution. If yes is chosen, all hand/factory programmed menus will be erased and overwritten.
EXIT	EXIT	Press ✓ button once to return exit to OFF.

Repeat the above procedures for each controller.

Cycle the control power again using the hidden reset momentary rocker switch under the left control box in gas or behind the right control box over the JIB in electric. **HOLD THE SWITCH FOR 15 SECONDS ENSURING THE MIB BOARD HAS POWERED FULLY DOWN** (see photos next page).

FilterQuick Software Update Instructions

For updating fryers with software versions 0524 and before with Serial Numbers THAT BEGIN WITH DATE CODES PRIOR TO 1601

*** Once all the fryer boards have rebooted it is necessary to take the handwritten recorded settings and enter them back into in the controllers for proper function of the fryer.

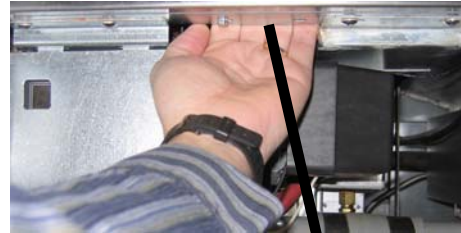

Location of switch on a gas fryer is behind the left control box.

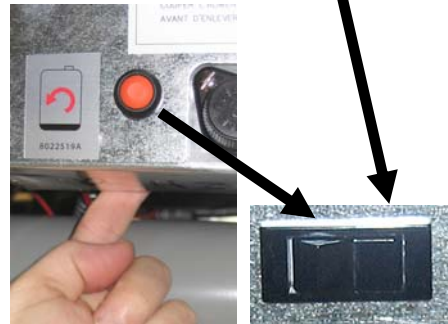

Location of switch on an electric fryer is behind the far right control box.

NOTE: If FILTER LOCKOUT was set to ENABLED prior to update set FILTER LOCKOUT to MAX to allow one bypass at the filter prompt before a filtration must occur. The new options for FILTER LOCKOUT are: NONE=Disabled, MIN=a filtration must occur at each prompt. No bypasses are allowed. MAX= allows a filter to be bypassed once. At the next filter prompt the vat must be filtered.