

# ABCs of Fryer Preventive Maintenance

## A: Filtration

- Remove the filter pan from the fryer and clean thoroughly.
- Remove all water from the components.
- Reassemble carefully. The bottom screen goes in first.
- Lay the filter paper in the pan, ensuring it rests against the wall.
- Place the hold-down ring in the pan, ensuring a couple of inches of paper is trapped against the wall of the filter pan.
- Add 8 ounces of filter powder.
- Return the cleaned crumb tray.
- Slide the filter pan into place under



Place the inner screen in first (above) and then the filter paper (below).

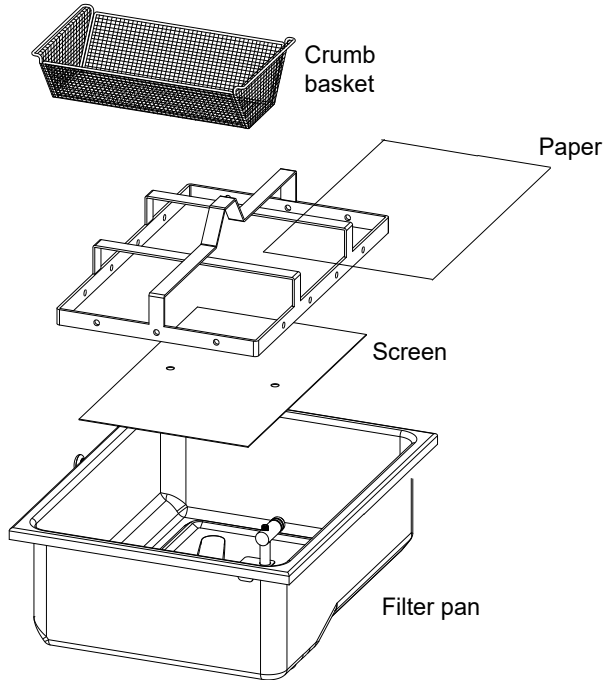

**\*NOTE:** The contents of the crumb tray should be dumped into a fireproof container daily.

the lid.

- Heat the oil to operating temperature; turn the fryer off. Open the drain valve on one frypot.
- The oil drains from the frypot. Leave the drain valve open.
- Pull the filter handle.

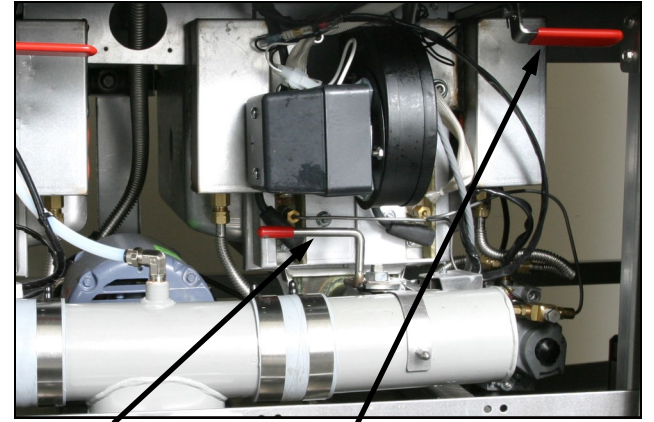

Drain valve Filter lever

- Allow the oil to flow for five minutes.
- Close the drain valve. Leave the filter pump on. The frypot fills.
- Allow the oil to bubble for 10 to 15 seconds to clear the oil return lines. Turn the filter pump off.
- Turn the fryer on and allow it to heat to operating temperature. Add more oil if necessary to raise the level to the upper etched line in the frypot.

## B: Cold Soak

- Drain and dispose of the old oil.
- Close the drain valve and fill the vat to the lower fill line with water and cleaner mixture.
- Scrub the fryer with a long-handled brush to remove stubborn stains.
- Allow the solution to soak for 1 hour.
- Drain the solution into a metal stockpot. Do not drain into the filter system or an SDU. **DO NOT USE** a plastic or glass bucket to drain the solution.
- Rinse the frypot with fresh water and dry completely.

- Refill the frypot with fresh oil to the lower etched line on the frypot.



Add cleaning solution to water in the frypot.



Scrub stubborn stains with a brush as the cleaning solution soaks in the frypot.



Drain slowly into a metal stockpot. Do not drain into the filter system or an SDU.

## C: Cleaning Blower

### High-efficiency gas units only

- Remove the blower motor and housing from the fryer.
- Remove the housing from the motor.
- Cover the motor with a plastic bag.
- Spray housing and blower wheel with degreaser.
- Rinse, removing oil, dirt and debris. Do not allow the motor to become wet.

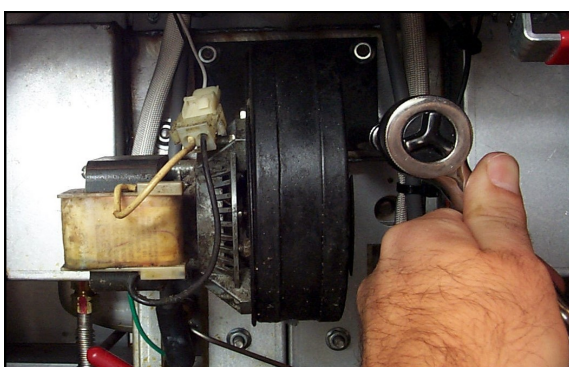

Remove the four bolts that hold the blower motor (above) to the fryer and disconnect the electrical connection. Clean the housing and wheel (right) while protecting the motor from moisture.

- Dry the blower assembly components and reassemble and reinstall on

**CAUTION**  
Wear protective clothing and use caution in all operations. Hot solutions can cause serious injuries.



the fryer. Repeat for all blower motors.